

MegPad

31.5" 4K Mobile Screen with Stand

A32Q7 MAX User Guide

The contents of the manual are for reference only,
and everything is subject to the actual product.

Contents

Safety Warnings and Precautions	2
Precautions	2
safety warning (stability hazard)	2
Important Statement on Network Service	2
Packing list	3
Product installation	4
Adjust angle and height	6
Functions Of Keys	7
Interface Functions	8
Base	9
Remote Control	10
Basic Operations	11
Power-on/Standby	11
Touch Operation	11
Attention	11
Wireless Network Connection	11
Cast Function	11
Signal Source	11
Technical Specifications	12
Product Warranty Card	13

Safety Warnings and Precautions

Precautions

1. Please read all instructions carefully before using the product.
2. When cleaning the mobile screen, please unplug the power cord, turn off the power switch, do not use liquid cleaning solution or spray cleaner, wipe the screen with a soft damp cloth, if it is still not clean, please use LCD screen cleaner.
3. Do not use accessories not recommended by the manufacturer, otherwise it may bring danger.
4. When unplugging the power cord of the chassis power interface or the power adapter, please hold the power plug with your hands and then unplug the power cord. Do not pull the power cord directly by hand to unplug it.
5. The mobile screen can only use the type of power supply shown on its nameplate. If you are in doubt about the type of power supply you are using, please consult your mobile screen dealer or local power supply bureau.
6. Since there will be high voltage or other dangers when opening or moving the case, please do not repair the mobile screen by yourself. You can contact qualified maintenance personnel for comprehensive maintenance.
7. In the following cases, first unplug the power plug of the bottom battery compartment or power adapter from the socket and contact a qualified maintenance personnel for maintenance:
 - a. Damaged or frayed power cord or power plug.
 - b. The mobile screen has been dropped or the case has been damaged.
 - c. When the display is obviously abnormal, it indicates that maintenance is required.
8. Please place the mobile screen in a well-ventilated environment away from strong light, high temperature or humidity.
9. Please store the mobile screen at room temperature of 0 °C~40 °C. If it exceeds this range, normal use may be affected.

safety warning (stability hazard)

The mobile screen may fall and cause serious injury. Many injuries, especially in children, can be avoided by taking simple precautions such as:

- Always use the cabinet, shelf or mounting method recommended by the mobile screen manufacturer.
- Be sure to use furniture that can safely support the mobile screen.
- Be sure to educate children about the dangers of climbing on furniture and touching the mobile screen or its controls.
- Always organize the wires and cables connected to the monitor to avoid tripping, pulling or grabbing.
- Do not place the mobile screen in an unstable or inclined position.
- To place the mobile screen on tall furniture (such as a cupboard or bookshelf), the furniture and monitor must be secured to a suitable support point.
- Never place the mobile screen on a cloth or other item that may be between the mobile screen and supporting furniture.
- Do not place toys, remote controls, etc., that may induce children to climb on the mobile screen or the furniture on which the mobile screen is placed.

To retain and relocate an existing monitor, take the same precautions as above.

Important Statement on Network Service

All contents and services obtained from the product are owned by third parties and protected by copyright, patent, trademark and/or other intellectual property laws. These contents and services are only for your personal non-commercial purposes, which shall not be used in a way not authorized by the content owner or service provider.

Under no circumstance shall our Company be liable for any direct, indirect or unexpected losses or damages arising from your or any third party's access to any contents or services or any information or third-party software through this product.

Third-party services may be subject to change, removal or discontinuation without prior notice. Our Company does not represent or warrant that some services or contents will remain accessible at any time.

Our Company will not be responsible for any service related to these contents and services, or assume any liability for customer service. For any question or service request about these contents and services, please directly contact your content or service provider.

Packing List



Monitor ×1

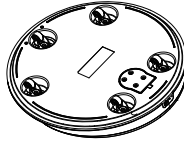

Round chassis ×1

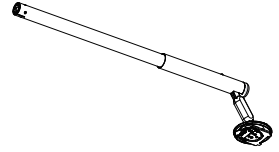

Lifting rod ×1



Power cord ×1

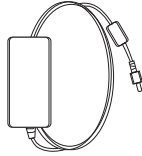

Adapter ×1



Remote control ×1

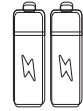

Battery ×2



Round trim
(at the rear of the machine)

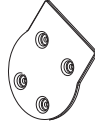

Base cover plate ×1

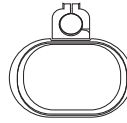

Cover ×1



Manual ×1



Quick Setup Instructions ×1



Phillips-head hex key wrench ×1

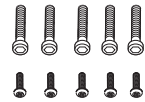

Long screws ×5
short screws ×5
(each includes 1 spare screw)

If any of the above are missing, please contact your product distributor.

Note: Please refer to the actual configuration for specific accessories. Please save all packaging materials for future removal.

Product Installation

Bracket Installation Instructions

01 Open the carton and remove the protective foam.

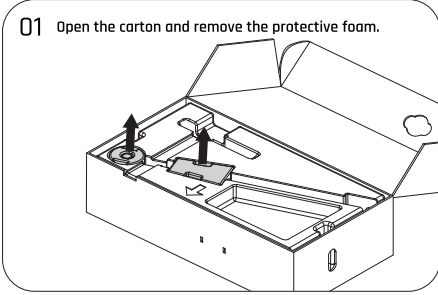

02 Remove the lifting pole from the first foam layer.

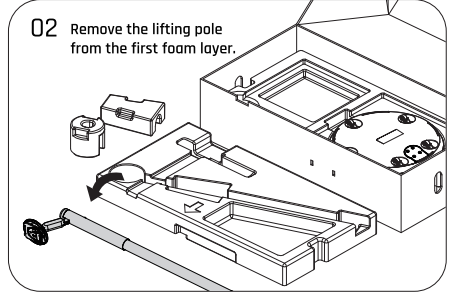

03 Remove the base plate from the second foam layer.

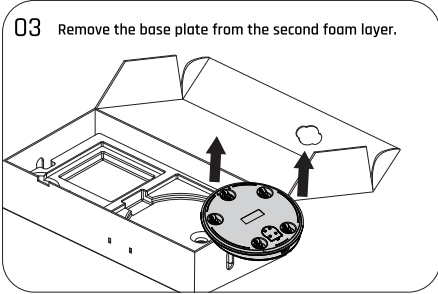

04 1. Place the round base plate into the slot on the first foam layer.
2. Align the grooves and insert the lifting pole to secure it.

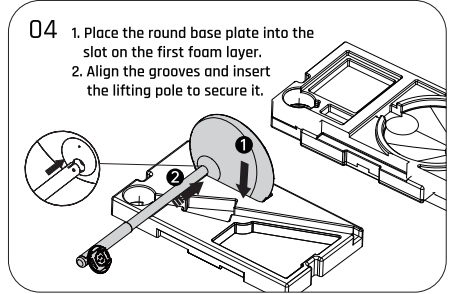

05 Tighten the locking screw for the lifting pole.



Secure to the base with
4 pcs long screws.

06 Tighten the screws for the base cover plate.

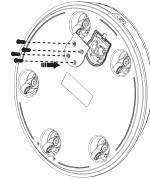

Secure the base cover plate to the
base with 4 pcs short screws.

Base support installation

When assembling, please be sure to tighten the bracket fixing screws, the bracket may fall and cause damage to the product or personal injury.

- The product has a certain weight, please ensure that at least two people work together to assemble it when unpacking and installing.
- Do not use foreign objects (oil, lubricating oil, etc.) on the screws when assembling the product.
- After the product is installed, do not remove the cable holder and screws.
- For daily use, make sure the product is moved in an upright position. If the product is too tilted, there is a risk of tipping over.

This can result in product failure or personal injury.

On-Screen Installation Instructions

07

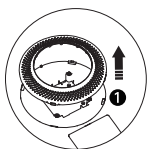

1. Take out the ring decorative cover on the back of the screen

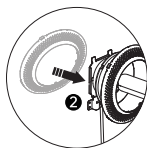

2. Tilt the ring trim cover through the lift rod (Place it in the lift rod first, then install it later)



08 1. Remove the cable clip from the top of the lifting pole.

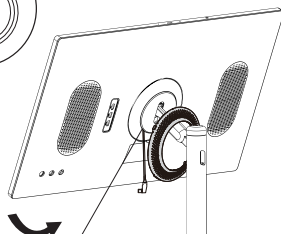
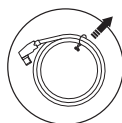

2. Tilt the screen up, install in alignment with the slot position



09

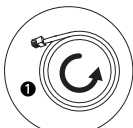

1. Counterclockwise winding of the power supply line



2. Plug in and secure the power supply line and confirm whether it can be switched on (As shown in Figure 11 Power-on Procedure)

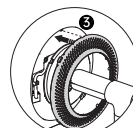

3. Position the slot on the top of the ring Aim at the top of the screen and press

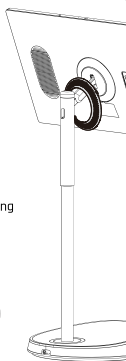

10

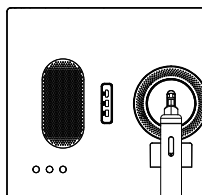

1. Use the hex key wrench to turn the screw counterclockwise and remove it. Keep the screw for future use.

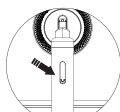

2. Reinstall the silicone plug into the hole. Press the lifting pole to unlock it, then adjust it to the desired height.

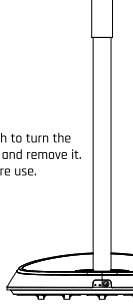

11

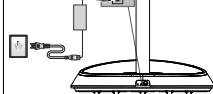
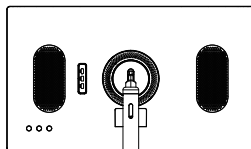

For the first installation and power-on, please connect the power adapter first.

Adjust angle and height

The height and angle of this product can be adjusted for a comfortable viewing experience.

Note: Some applications do not support vertical display.

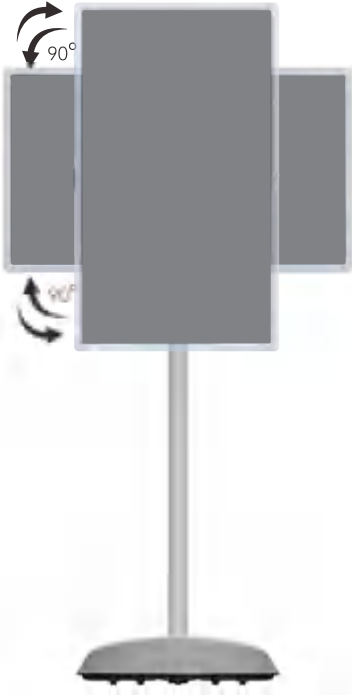

Forward tilt angle: $20\pm 3^\circ$
Backward tilt angle: $20\pm 3^\circ$



The lifting rod can adjust the height
 $200\pm 10\text{mm}$



Caution

- Do not rotate the product beyond its limit angle or exceed the maximum height adjustment range.
- Do not allow your hands or fingers to be caught in the bracket or height adjustment area.

Functions Of Keys





Functions of Keys

ON/OFF: Turn on or off the product.



Power button

- In standby/screen-off mode, press  button to turn on the product.
- During normal working, press  button to enter screen-off state;
- From the drop-down menu on screen, click " > **System > Gestures > Press & hold power button**", then click "**Power menu**" or "**Digital assistant**" to set functions of "Press & hold power button" as needed.



VOL+: Increase the volume.



VOL- : Decrease the volume.

Interface Functions

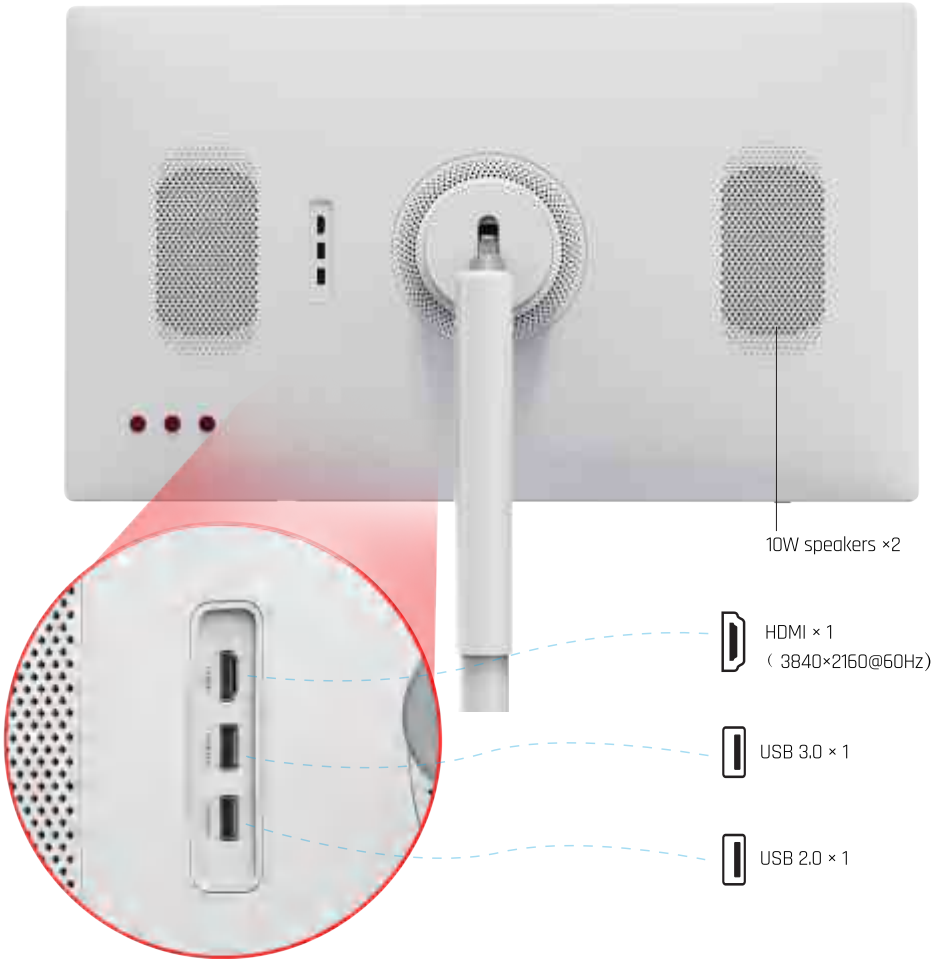

HDMI : External Devices Supported external devices include: game consoles, computers, Blu-ray players, high-definition receivers, DVD players, and other external devices.

USB: Can use a USB storage device, or for a mouse and keyboard receiver.

Base

This product stand contains a built-in battery, allowing it to be used for a period of time without connecting to an external power source. When the device is powered on, the battery indicator light shows three different states (red / orange / green) based on the remaining battery level, as shown below.



Power connected

31%≤Battery level ≤ 100%, the green indicator stays on.

When fully charged, the green indicator blinks slowly.

Battery level normal

11%≤Battery level ≤ 30%, the orange indicator stays on.

Low battery

Battery level ≤ 10%, the red indicator stays on.

10W speakers ×2



Caution

- Battery life and operating time after charging will decrease proportionally with product usage over time.
- Do not charge the battery in extreme environments.
- In standby mode, the remaining battery level will also decrease naturally and gradually.
- To extend battery life, it is recommended to charge the battery after using it for a period of time, rather than keeping it fully charged at all times.
- Keeping the battery level at around 50% helps extend battery life.
- The standard operating time stated in this manual is based on values measured in the KTC laboratory; actual time may vary depending on usage conditions.
- Operating time may vary due to various factors, such as connected devices, operating temperature, usage duration, and user settings.

Remote Control

Before using the remote control, please make sure it has been successfully paired.
If it has not been paired yet, go to Settings > Connected devices > Remote Control Pairing Tutorial, and follow the on-screen instructions to complete the pairing process.



Flying Squirrel

Toggle the [On/Off] state of the flying squirrel mode.



Return

Return to the previous level.



User settings

Enter settings.



Home Page

Return to the desktop homepage.



Mute

Turn on mute.



Volume

Increase the volume.



Volume

Decrease the volume.



Arrow keys

Up: Simulate the operation of swiping from top to bottom with touch control.

Down: Simulate the operation of swiping from bottom to top with touch control.

Left: Switch to the left page;

Right: Switch to the right page.

 : Confirm the selected content.



Power

Short press: Turn off the screen.

Long press: Enter the [Shutdown Confirmation Page] or wake up the Google Assistant.

(displayed according to the options set in the settings)

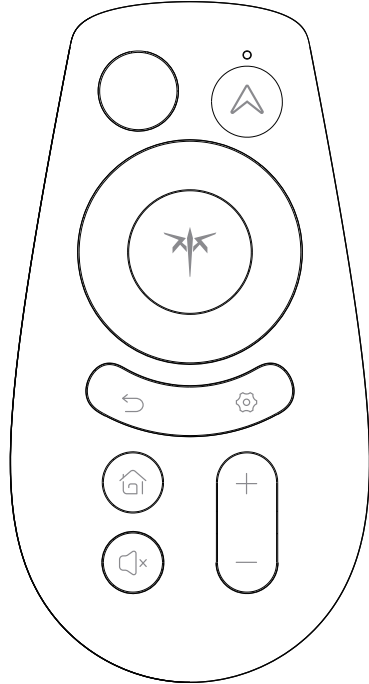

Basic Operations

Power-on/Standby

Connect the power cord, and press the **[Main switch]** key on the base to turn on the product. During normal working, swipe down from the top edge, and drop-down menu appears. Click "**☰ > Power off**", then the product enters standby state. Press **[Restart]** can reboot the machine.

Touch Operation

- Click: Tap on the screen.
- Click and hold: Tap on the screen for 2s or longer.
- Swipe: Swipe on the screen up, down, left and right.
- Drag: Tap and hold the target (e.g., an application) to be moved, then swipe to the desired position.
- Open/close: Place two fingers on the screen, then open or close these fingers to zoom in or out the content displayed on the screen.

Note: After the screen is off, double click to make the screen on.

Click "**Settings > System > Gestures > System navigation**" to select the system navigation mode.

Attention:

- Whether the displayed content supports the zoom in/out function is related to the application. Please operate according to the actual condition.
- Avoid pressing the screen with force; where necessary, simply use your fingertip to tap on the desired item. If you wear gloves or use your fingernail to touch the screen, it is possible that the product cannot respond and be operated normally.
- If the screen is a little wet or too damp, the sensor cannot work normally when touching it.

Wireless Network Connection

Click "**Settings > Network & internet > Internet**", and turn on WiFi; the system will start searching and list the wireless network signals available. Click the network to be connected. The  icon beside a network indicates the network is encrypted; the product can be connected to the network only after you enter the correct password.

Remark: More system settings can be done under "Settings" as per need.

Cast Function

Click "**Cast**"; select the projection mode according to the device used. Perform projection according to different prompts.

Signal Source

When a device is connected via HDMI, click on "Signal Source" to switch to the HDMI input (the external device must support HDMI screen casting).

Technical Specifications

Panel size	80.01 cm (31.5 inches)
Maximum Resolution	3840×2160@60Hz
Panel type	VA
Backlight type	Side Entry (ELED)
Built-in system	Powered by Android™ 13
Charging interface	19V == 4.74A,90W
Visible area	697.3mm×392.2mm
Viewing angle	178° (H) / 178° (V)
Color gamut	90% DCI-P3
Center luminance of White	200cd/m ² (Typ)
Contrast	3000(Typ)/2700(Min)
Speaker	2×10W+2×10W
Battery capacity	9500mAh/14.4V(136.8Wh)
Product interface	HDMI2.0×1 USB2.0×1 USB3.0×1 power interface×1
Work environment requirements Working temperature and humidity Working altitude Storage temperature and humidity	0℃ ~ 40℃ 0% ~ 65%(non-condensing) ≤3000m -10℃ ~ 50℃ 0% ~ 80%(non-condensing)

Low blue light mode

The light emitted by the screen contains blue light, and keeping the eyes on the screen for long periods of time will not only bring visual fatigue, but also may cause eye diseases. Using the low blue light function will reduce blue light and reduce eye fatigue.

The default mode of the product is the low blue light mode, which is certified by the TUV Rheinland hardware method for low blue light.

Eye care recommendations :

- 1) Do not use the product for a long time without interruption, avoid overuse of the eyes, it is recommended that you take a 10 minute break for every 30 minutes of use.
- 2) When taking a break, you can relax your eyes by looking at distant scenery.
- 3) When taking a break, do eye exercises to relax your eyes.
- 4) Infants under the age of 2 should not watch the screen.

Product Warranty Card



Customer Name	
Tel	
Address	
Model	
Device Number	
Purchase Date	

Warranty Rules

1. We provide you with one year free warranty from the date of purchase or as agreed in the contract.
2. The following cases are not covered by the warranty:
 - Failure or damages caused by artificial or natural disasters.
 - Failure caused by not following the operation method and precautions written in the User Guide.
 - Failure caused by user disassembly.
3. The liability scope of the warranty card is limited to the maintenance of the product, without covering any other liability.
4. If you are not sure about the repair and warranty of the machine after the warranty period, please visit the website US.KTCDPLAY.COM for the warranty policy.



Notice: Please fill out the card and return it to us, when you apply for a warranty.



More Information
Please scan QR code or visit US.KTCPLAY.COM

Any question or comments. Please contact:

support@ktcplay.com

support.eu@ktcplay.com [Europe]

HDMI™

The terms HDMI and HDMI High-Definition Multimedia Interface, and the HDMI Logo are trademarks or registered trademarks of HDMI Licensing Administrator, Inc. in the United States and other countries.